



MOTORIZED BLIND

# Motorized Roller

Motorized roller shades utilize tubular motors that are hidden within the shade roller. The shades can be controlled via standard 3 position wall switches, wireless remote controls, programmable smart switches and even smart devices or PCs with customizable software. Power for the motors can come from line voltage AC, DC transformers or lithium-ion batteries.



With a host of automatic controls such as sun and light sensors, building facades and window walls become bioclimatic. Solar shades react to weather variations to then offer occupants greater comfort while saving energy.

## Power Source Options

### Battery/Solar (12v) Powered

Shades up to 12'x12'

When running wiring is not an option our new wireless motors with either internal rechargeable lithium-ion batteries or external battery wands are perfect. Optional solar panels for recharging batteries is available.



### Low Voltage DC (24v) Powered

Shades up to 14'x14'

Very quiet operation. When installing an AC plug or outlet near head of window is difficult: Uses light gauge wiring & connectors.



### AC (110v) Powered

Shades up to 40'x40'

Very quiet operation, rugged high performance motors. Larger gauge wiring & plugs. Up to 5 shade bands can be coupled together and ran on a single motor.



## Control Options

### RF (radio)



Radio technology is the most flexible form of communication with any motor. Wireless hand held remote controls, wall switches & timers are easily added and programmed for a job at any point in time. Individual shades or groups of shades can be controlled in any arrangement. Sun sensors, external AV controllers or even smart devices can be integrated with the RF platform.

### WIRED TECHNOLOGY



In new construction and in many commercial applications where RF interference may be an issue, low voltage or line voltage electrical wiring links the controls to the motors. Sun sensors and external AV equipment can be integrated with the wired platform via dry contact or serial interfaces.

### AUTOMATED Controls



Somfy's animeo IP system provides comprehensive solar management for commercial buildings via programmed controllers, sensors, digital keypads or third party AV equipment. With natural light management and dynamic insulation values Animeo can obtain up to 19 LEED points. See page 5 for more information.

## Shade System Options



Open-Roll



Cassette



Fascia

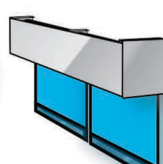

Coupled  
Open-Roll or with  
Fascia

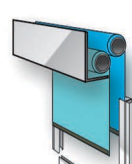

Dual Shades  
Open-Roll or with  
Fascia

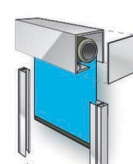

Pockets



Summer Strategy



Winter Strategy

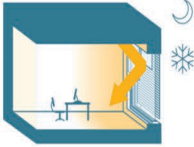

**Dynamic Insulation**

Automated motorized window coverings are raised and lowered according to changes in outdoor weather conditions and indoor comfort needs based on commands from sensors, pre-programmed settings, or local occupant controls.

**Device Management**

An intuitive user interface allows for simplified commissioning, building management and technical support, featuring drag-and-drop programming, motor auto discovery, and at-a-glance real-time system status updates.



Below is an example of how scalable Somfy solutions are. From a single room, to individual floors or rooms, to an entire building, animeo® IP and Somfy Digital Network™ [SDN] installations are suitable for every jobsite. [SDN] installations are suitable for every jobsite.

Single Room

For smaller installations, a standard Somfy Digital Network installation is a powerful yet economical solution. Local controls, including Somfy's full range of wired and wireless controls, can be added for convenient access.

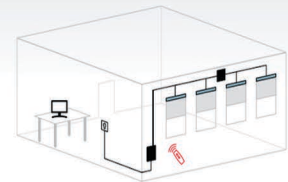

Individual Floor

To automate up to 200 motorized shades based on sun, wind, temperature and rain thresholds, incorporate animeo IP into a Somfy Digital Network installation for the next level of control. animeo IP uses a dedicated range of sensors as well as schedules for automated solar management while still allowing occupants to make adjustments using in-wall keypads or virtual keypads. The system's graphic user interface simplifies commissioning, operation and troubleshooting.



animeo IP Building Controller

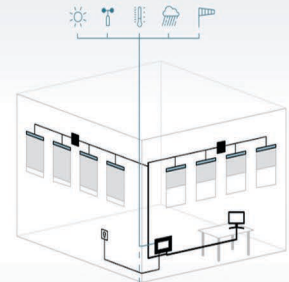

Multiple Floors or Entire Building

For installations greater than 200 motors, add animeo IP Sub Controllers to expand system capacity [1 for every additional 200 motors]. The scalable technology of both Somfy Digital Network and animeo IP make them ideal solutions for larger installations where centralized control is a necessity. animeo IP can also be integrated into third party BMS, EMS and AV systems.



animeo IP Sub Controller



animeo IP Sub Controller

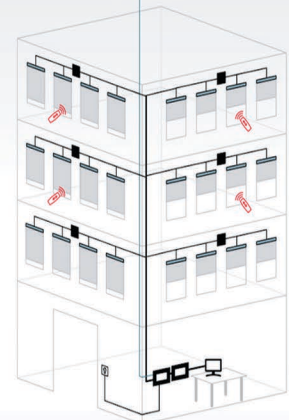

pg.05 roller shade systems

## MOTORIZEDROLLERSHADE ST30DCMOTOR(RTS)

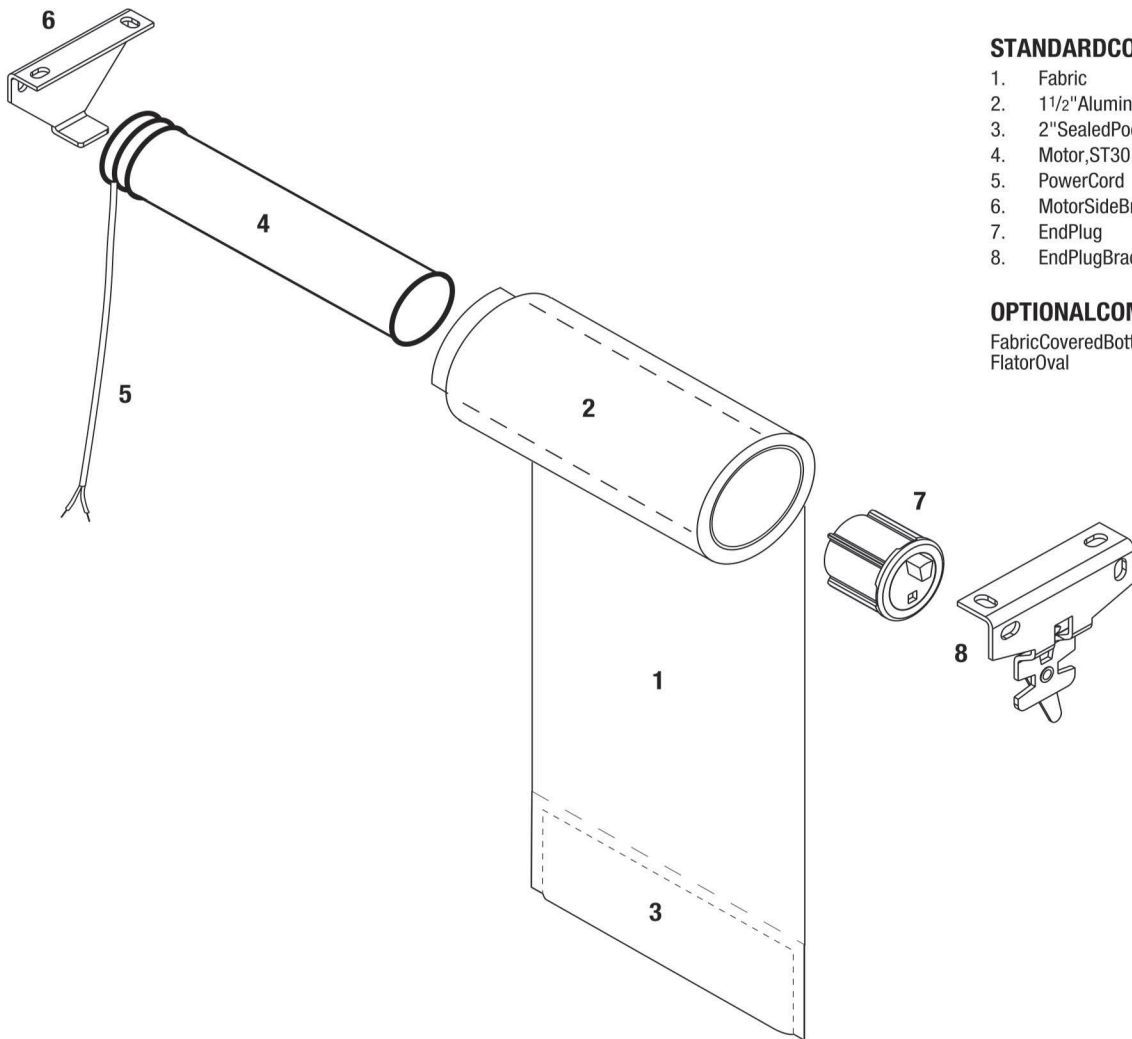

### STANDARDCOMPONENTS:

1. Fabric
2. 1 1/2" Aluminum Roller Tube
3. 2" Sealed Pocket Hem Bar
4. Motor, ST30
5. Power Cord
6. Motor Side Bracket
7. End Plug
8. End Plug Bracket

### OPTIONALCOMPONENTS:

Fabric Covered Bottom Bar,  
Flator Oval

### TRANSFORMERDIMENSIONS:

MOTOR MODEL	OUTPUT	INPUT	HEIGHT	LENGTH	WIDTH
ST30	24V-1.125A	AC100-240V ~ 50/60Hz 0.7A	1.25"	3.75"	2.0"
ST30	24V-10A	AC100-240V ~ 50/60Hz 3.5A	4.0"	4.9375"	4.9375"
ST30	24V-5A (On Switch)	AC100-120V ~ 50/60Hz 3.3A	4.0"	4.9375"	2.5625"
		AC200-240V ~ 50/60Hz 2.0A	4.0"	4.9375"	2.5625"

### SHADESIZES&WEIGHTS:

MOTOR MODEL	SHADE WIDTH	SHADE DROP	MAXIMUM WEIGHT
ST30	20"-72"	12"-96"	12lbs.

### BRACKETPROJECTIONS:

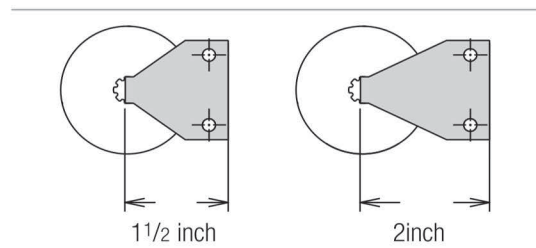

## COMPONENTDIMENSIONS

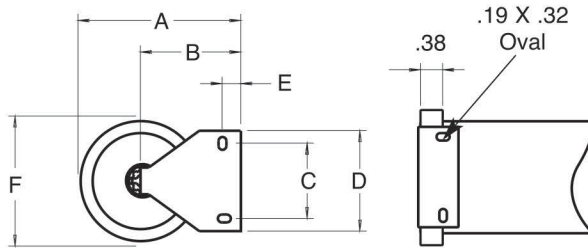

**Outside &  
Inside Mount**

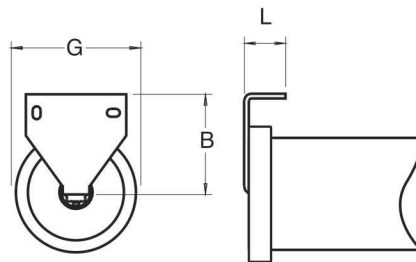

**Ceiling Mount**

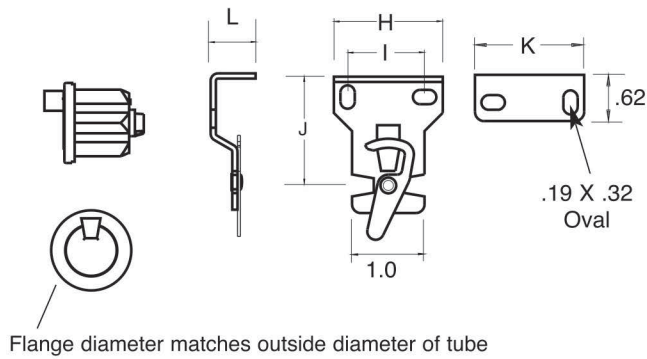

**End Plug and  
Bracket with  
Retainer**

### COMPONENTDIMENSIONS:

MOTOR MODEL	BRACKET MODEL	A	B	C	D	E	F	G	H	I	J	K	L
ST30	1 1/2" Projection	2.48"	1.5"	1.06"	1.5"	0.28"	1.95"	1.95"	1.5"	1.125"	1.5"	1.5"	0.62"

# MOTORIZED ROLLERSHADE

## ST50 MOTOR (RTS) / ST50 MOTOR (STANDARD) / LS40 MOTOR (STANDARD)

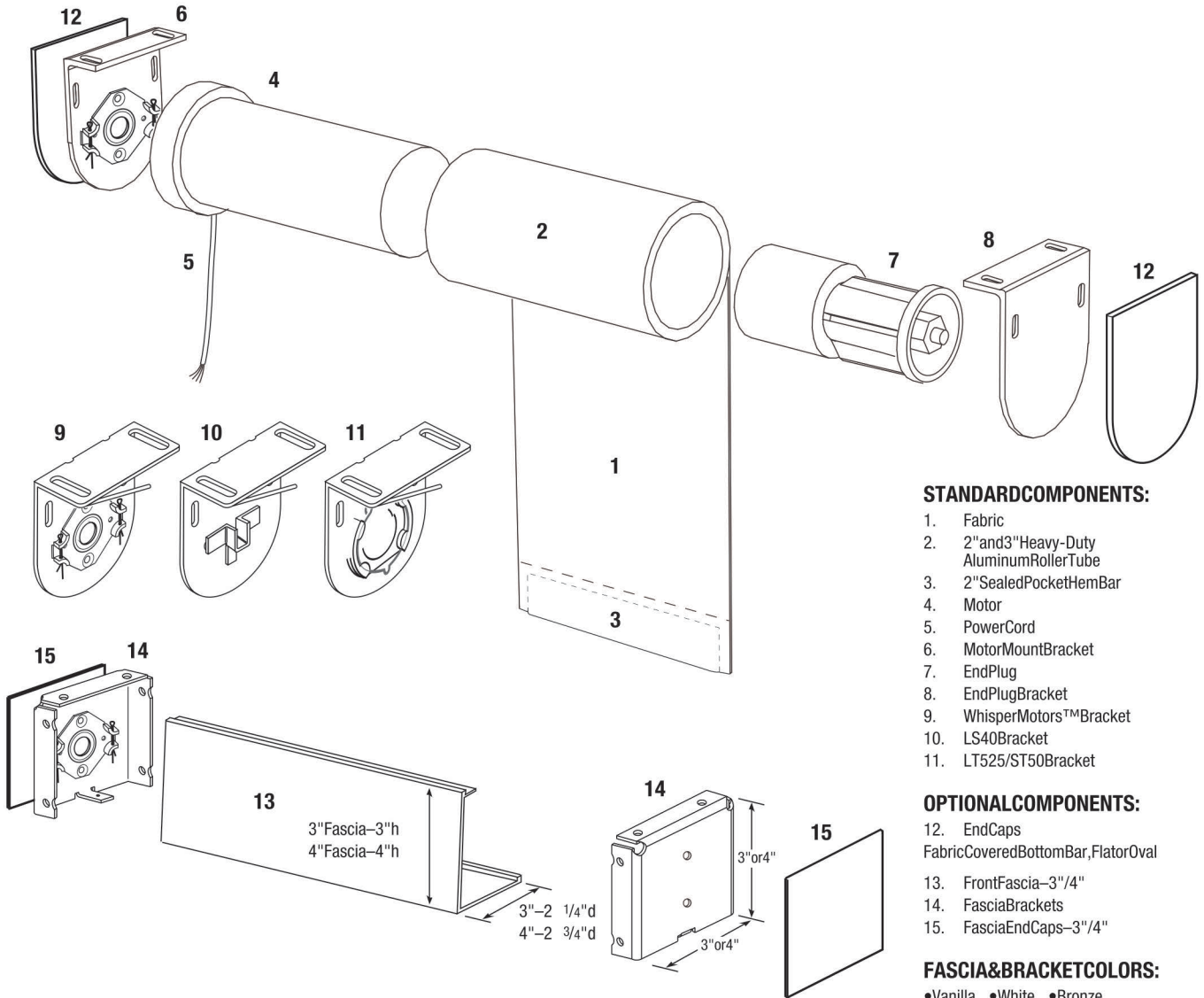

### STANDARD COMPONENTS:

1. Fabric
2. 2" and 3" Heavy-Duty Aluminum Roller Tube
3. 2" Sealed Pocket Hem Bar
4. Motor
5. Power Cord
6. Motor Mount Bracket
7. End Plug
8. End Plug Bracket
9. WhisperMotors™ Bracket
10. LS40 Bracket
11. LT525/ST50 Bracket

### OPTIONAL COMPONENTS:

12. End Caps
- Fabric Covered Bottom Bar, Flator Oval
13. Front Fascia—3"/4"
14. Fascia Brackets
15. Fascia End Caps—3"/4"

### FASCIA & BRACKET COLORS:

- Vanilla • White • Bronze
  - Anodized • Black
- (See page 4-2 for color chart.)

### SHADE SIZES & WEIGHTS:

MOTOR MODEL	RPMs	SHADE WIDTH	SHADE DROP	MAXIMUM WEIGHT
ST50RTS	30rpm	45"–156"	12"–192"	24lbs.
ST50Std	30rpm	45"–156"	12"–192"	24lbs.
LS40Std	30rpm	26"–44 7/8"	12"–192"	20lbs.

### BRACKET PROJECTIONS:

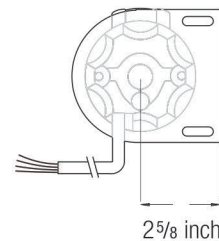

## COMPONENTDIMENSIONS

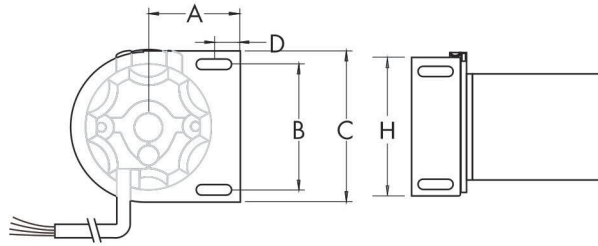

**Outside &  
Inside Mount**

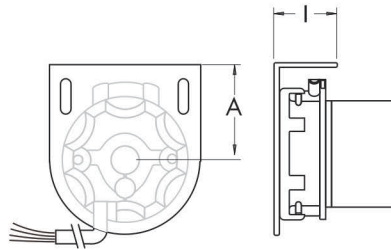

**Ceiling Mount**

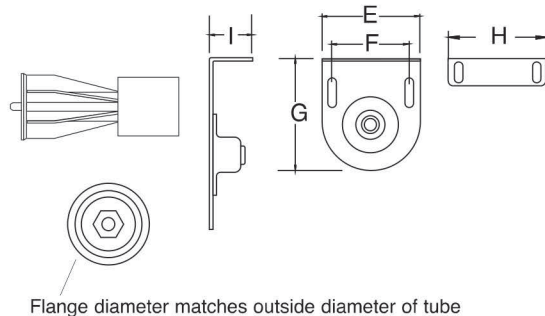

**End Plug and  
Bracket with  
Retainer**

### COMPONENTDIMENSIONS:

MOTOR MODEL	BRACKET MODEL	A	B	C	D	E	F	G	H	I
ST50RTS	2 <sup>5</sup> / <sub>8</sub> "Projection	2 <sup>5</sup> / <sub>8</sub> "	2 1/2"	3 1/4"	7/8"	3 1/4"	2 1/2"	4 1/4"	3 1/4"	1 5/8"
ST50Std	2 <sup>5</sup> / <sub>8</sub> "Projection	2 <sup>5</sup> / <sub>8</sub> "	2 1/2"	3 1/4"	7/8"	3 1/4"	2 1/2"	4 1/4"	3 1/4"	1 5/8"
LS40Std	2 1/8"Projection	2 1/8"	2 3/8"	3 1/8"	1 1/8"	3 1/8"	2 3/8"	3 3/4"	3 1/8"	1 3/8"

# MOTORIZED BANDED ROLLERSHADE

## ST50 MOTOR(RTS)/ST50 MOTOR(STANDARD)/LS40 MOTOR(STANDARD)

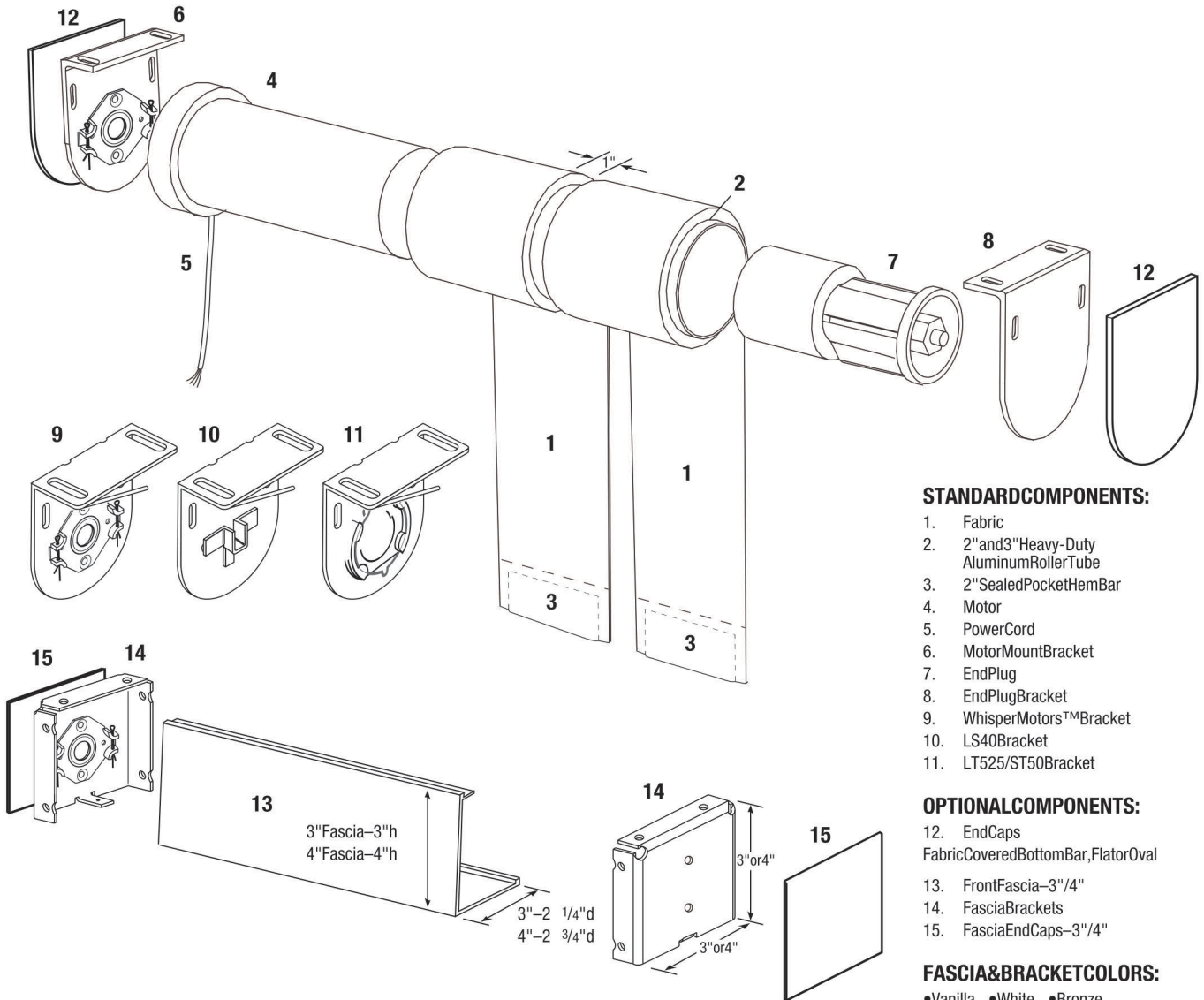

### STANDARD COMPONENTS:

1. Fabric
2. 2" and 3" Heavy-Duty Aluminum Roller Tube
3. 2" Sealed Pocket Hem Bar
4. Motor
5. Power Cord
6. Motor Mount Bracket
7. End Plug
8. End Plug Bracket
9. Whisper Motors™ Bracket
10. LS40 Bracket
11. LT525/ST50 Bracket

### OPTIONAL COMPONENTS:

12. End Caps  
Fabric Covered Bottom Bar, Flator Oval
13. Front Fascia—3" / 4"
14. Fascia Brackets
15. Fascia End Caps—3" / 4"

### FASCIA & BRACKET COLORS:

- Vanilla •White •Bronze
  - Anodized •Black
- (See page 4-2 for color chart.)

### SHADE SIZES & WEIGHTS:

MOTOR MODEL	RPMs	SHADE WIDTH	SHADE DROP	MAXIMUM WEIGHT
ST50RTS	30rpm	45"–156"	12"–192"	24lbs.
ST50Std	30rpm	45"–156"	12"–192"	24lbs.
LS40Std	30rpm	26"–44 7/8"	12"–192"	20lbs.

### BRACKET PROJECTIONS:

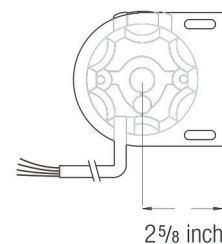

LOUV.O.LUX

Windows Fashion, and Beyond.



# MOTORIZED ROLLER SHADE WITH 3" FASCIA, TOP COVER & BLOCKOUT SYSTEM ST30DC MOTOR (RTS)

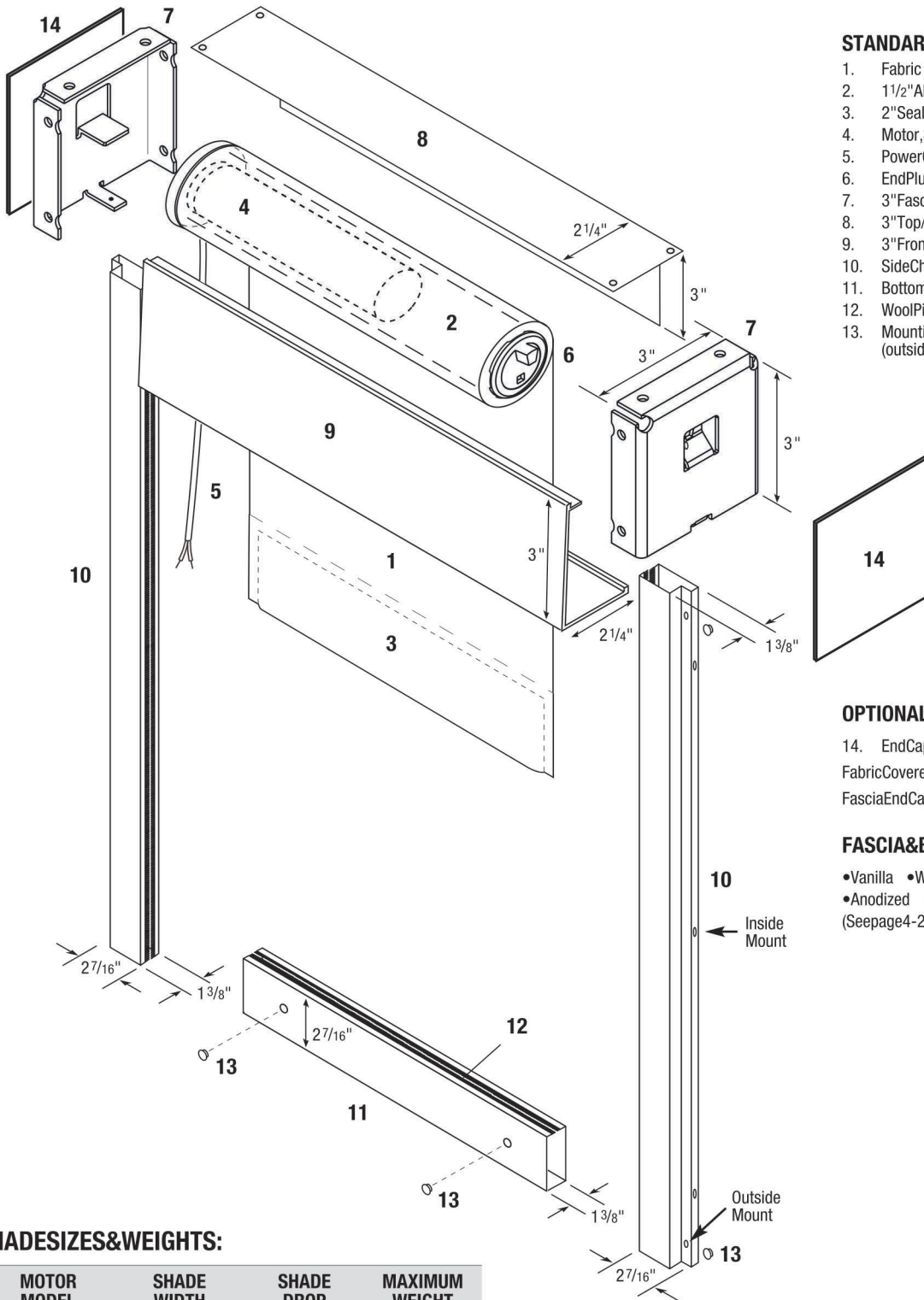

## STANDARD COMPONENTS:

1. Fabric
2. 1 1/2" Aluminum Roller Tube
3. 2" Sealed Pocket Hem Bar
4. Motor, ST30
5. Power Cord
6. End Plug
7. 3" Fascia Brackets
8. 3" Top/Back Fascia—3"hx2 1/4"d
9. 3" Front Fascia—3"hx2 1/4"d
10. Side Channels—2 7/16"wx1 3/8"d
11. Bottom Channel—2 7/16"hx1 3/8"d
12. Wool Pile
13. Mounting Hole Plugs (outsidemountonly)

## OPTIONAL COMPONENTS:

- 14. End Caps
- Fabric Covered Bottom Bar, Flat
- Fascia End Caps

## FASCIA & BRACKET COLORS:

- Vanilla • White • Bronze
  - Anodized • Black
- (See page 4-2 for color chart.)

## SHADE SIZES & WEIGHTS:

MOTOR MODEL	SHADE WIDTH	SHADE DROP	MAXIMUM WEIGHT
ST30	20"–72"	12"–72"	12lbs.

**MOTORIZED ROLLERSHADE WITH 4" FASCIA, TOP COVER & BLOCKOUT SYSTEM  
ST50 MOTOR (RTS) / ST50 MOTOR (STANDARD)**

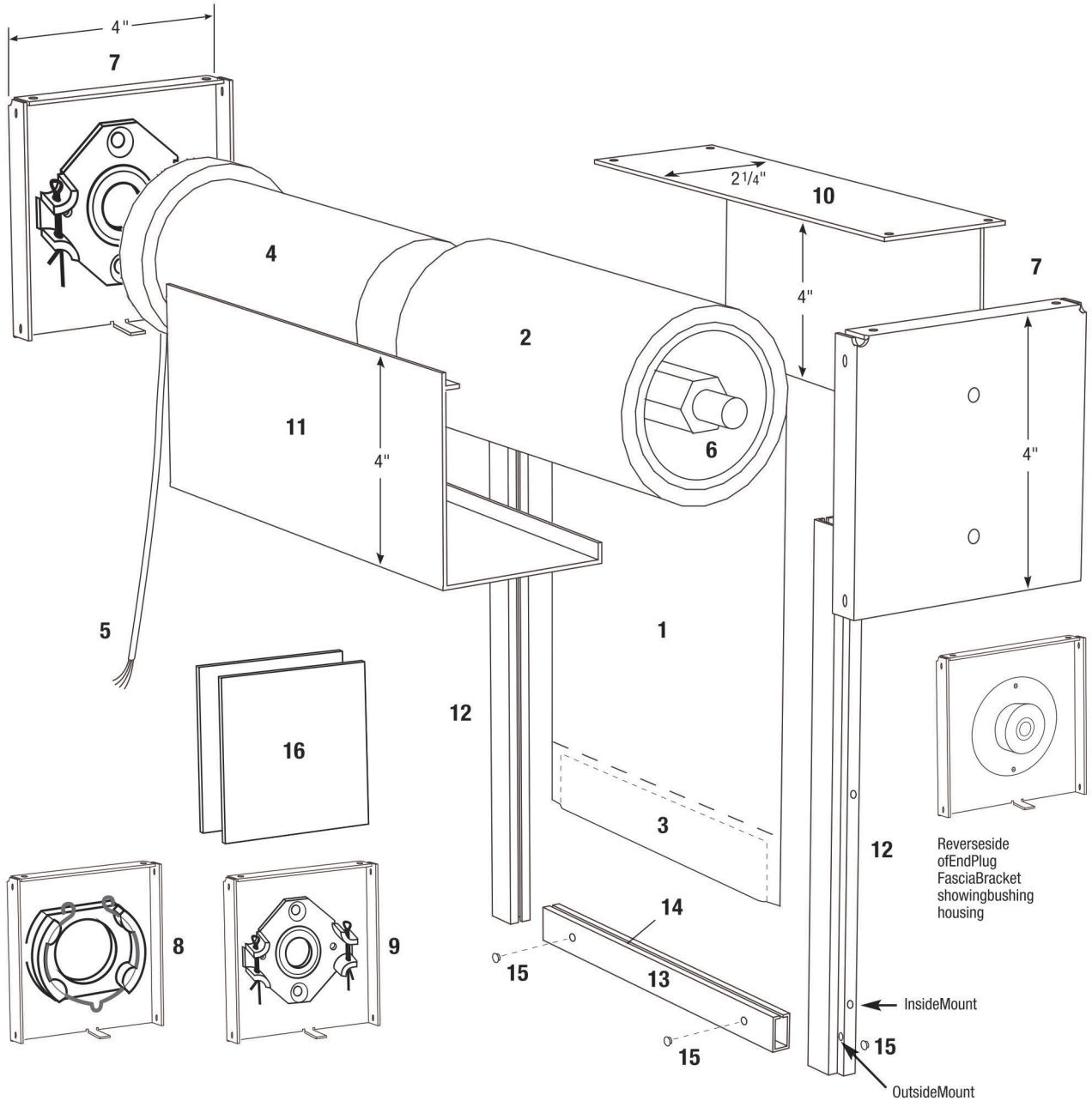

**SHADE SIZES & WEIGHTS:**

MOTOR MODEL	SHADE WIDTH	SHADE DROP	MAXIMUM WEIGHT	TUBE SIZE 4" FASCIA	MAXIMUM ROLL-UP DIAMETER*
ST50RTS	45"-156"	12"-144"	24lbs.	2"	3 7/8"

# MOTORIZED ROLLER SHADE WITH 4" FASCIA, TOP COVER & BLOCKOUT SYSTEM ST50 MOTOR (RTS)/ST50 MOTOR (STANDARD)

## STANDARD COMPONENTS:

1. Fabric
2. 2" Roller Tube
3. 2" Sealed Pocket Hem Bar
4. Motor
5. Power Cord
6. End Plug
7. 4" Fascia Brackets
8. Motor Bracket
9. Whisper Motors™ Bracket
10. 4" Top/Back Fascia—4"hx2 3/4"d
11. 4" Front Fascia—4"hx2 3/4"d
12. Side Channels—2 7/16"wx1 3/8"d
13. Bottom Channel—2 7/16"hx1 3/8"d
14. Wool Pile
15. Mounting Hole Plugs (outsidemountonly)

## OPTIONAL COMPONENTS:

16. Fascia and Pocket End Caps
- 4" Pocket Profile
- 5.25" & 9" Pocket Profile
- Fabric Covered Bottom Bar, Flat

## FASCIA & BRACKET COLORS:

- Vanilla • White • Bronze
  - Anodized • Black
- (See page 4-2 for color chart.)

## POCKET PROFILES:

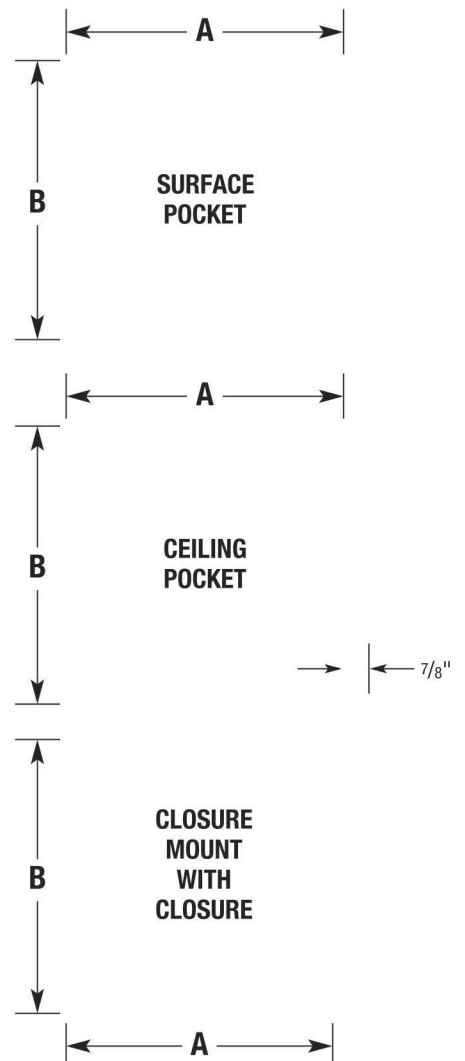

## POCKET DIMENSIONS:

POCKET SIZE	WIDTH A	HEIGHT B
Surface Pocket	5 1/4"	5 1/4"
	9"	9"
Ceiling Pocket	5 1/4"	5 1/4"
	9"	9"
Closure Mount (B) with 2" Closure (A)	2"	2 5/16"
Closure Mount (B) with 3" Closure (A)	3"	2 5/16"
Closure Mount (B) with 5" Closure (A)	5"	2 5/16"

# DUALMOTORIZEDCOUPLED SHADES WITH FASCIA LT525MOTOR(RTS)/LT525MOTOR(STANDARD)

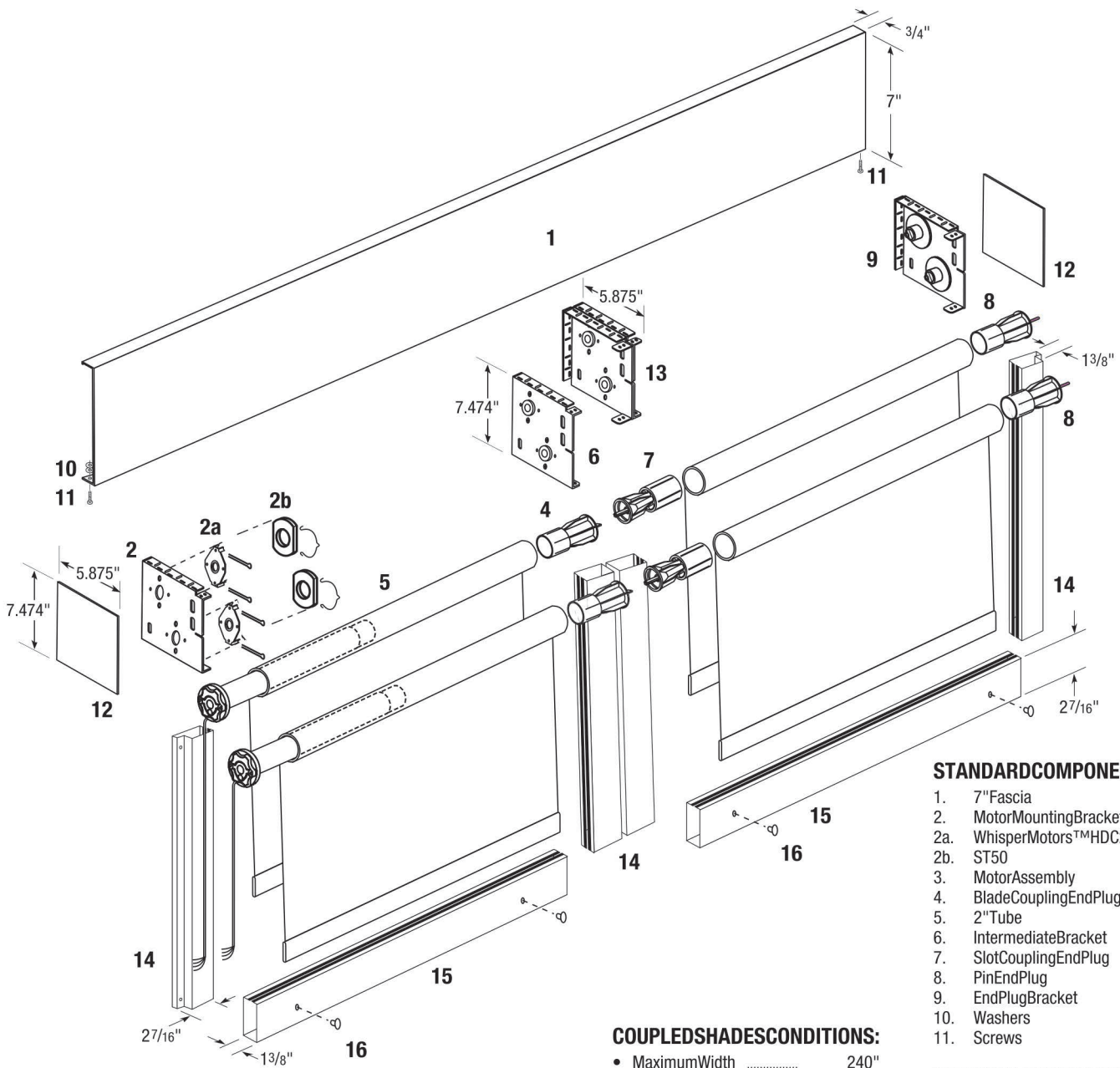

### STANDARD COMPONENTS:

1. 7" Fascia
2. Motor Mounting Bracket
- 2a. WhisperMotors™ HDC200S
- 2b. ST50
3. Motor Assembly
4. Blade Coupling End Plug
5. 2" Tube
6. Intermediate Bracket
7. Slot Coupling End Plug
8. Pin End Plug
9. End Plug Bracket
10. Washers
11. Screws

### COUPLED SHADES CONDITIONS:

- Maximum Width ..... 240"
- Maximum Number of Bands ..... 6
- Maximum Width of Band ..... 120"
- Minimum Width of Band Non-Motor Band ..... 20"
- Motor End Minimum Width  
HDC200S ..... 31"  
LT525 ..... 35"
- Tube ..... 2"

### FASCIA & BRACKET COLORS:

- Vanilla • White • Bronze
  - Anodized • Black
- (See page 4-2 for color chart.)

### OPTIONAL COMPONENTS:

12. Fascia End Plate
13. Intermediate Bracket For Adjoining Two Fascias
14. Blockout Side Channel
15. Blockout Bottom Channel
16. Mounting Hole Plugs  
Fabric Covered Bottom Bar, Flat

### SHADE SIZES & WEIGHTS:

MOTOR MODEL	SHADE WIDTH	SHADE DROP	MAXIMUM WEIGHT	TUBE SIZE	MAXIMUM ROLL-UP DIAMETER*
LT525Std/RTS-Single Fascia	35"-192"	12"-144"	24lbs.	2"	3.5"
LT525Std/RTS-Individual Fascia	35"-240"	12"-144"	24lbs.	2"	3.5"

# DUALMOTORIZEDSHADEWITHFASCIA ST50MOTOR(RTS)/ST50MOTOR(STANDARD)

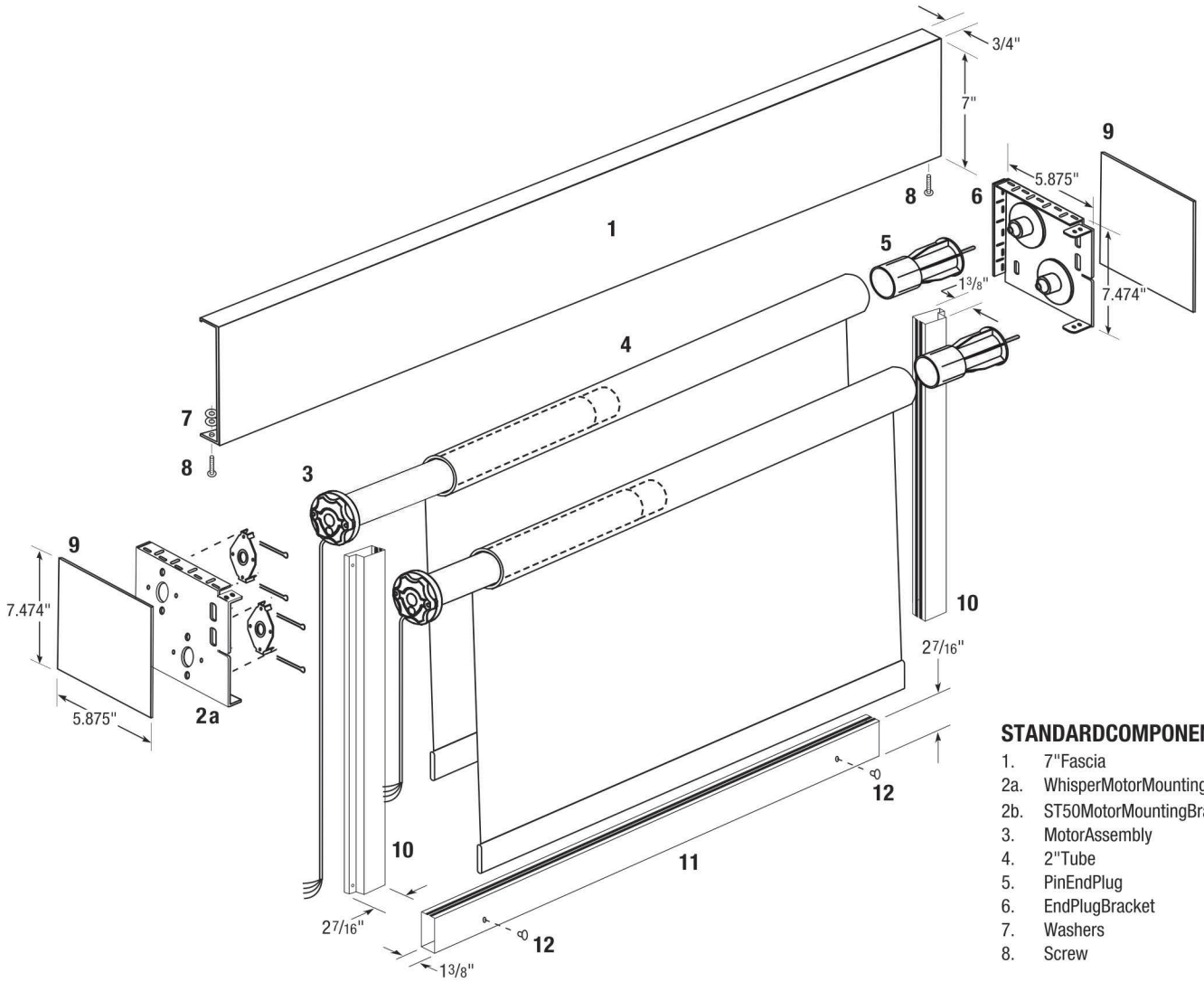

## STANDARD COMPONENTS:

1. 7" Fascia
- 2a. Whisper Motor Mounting Bracket
- 2b. ST50 Motor Mounting Bracket
3. Motor Assembly
4. 2" Tube
5. Pin End Plug
6. End Plug Bracket
7. Washers
8. Screw

## OPTIONAL COMPONENTS:

9. Fascia End Plate
10. Blockout Side Channel
11. Blockout Bottom Channel
12. Mounting Hole Plugs
- Fabric Covered Bottom Bar, Flat

## FASCIA & BRACKET COLORS:

- Vanilla • White • Bronze
  - Anodized • Black
- (See page 4-2 for color chart.)

## POCKET PROFILES:

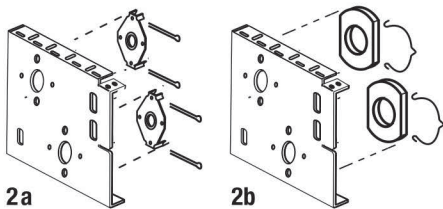
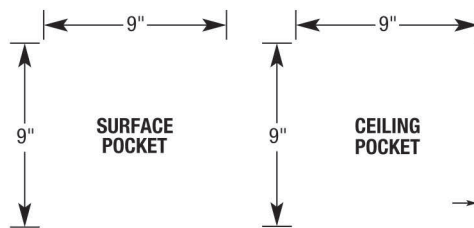

## SHADE SIZES & WEIGHTS:

MOTOR MODEL	SHADE WIDTH	SHADE DROP	MAXIMUM WEIGHT	TUBE SIZE	MAXIMUM ROLL-UP DIAMETER*
ST50RTS	45"-156"	12"-144"	35lbs.	2"	4 <sup>5</sup> / <sub>8</sub> "
ST50Std	45"-156"	12"-144"	35lbs.	2"	4 <sup>5</sup> / <sub>8</sub> "

# DUALMOTORIZEDSHADEWITHFASCIA

## ST50MOTOR(RTS)/ST50MOTOR(STANDARD)

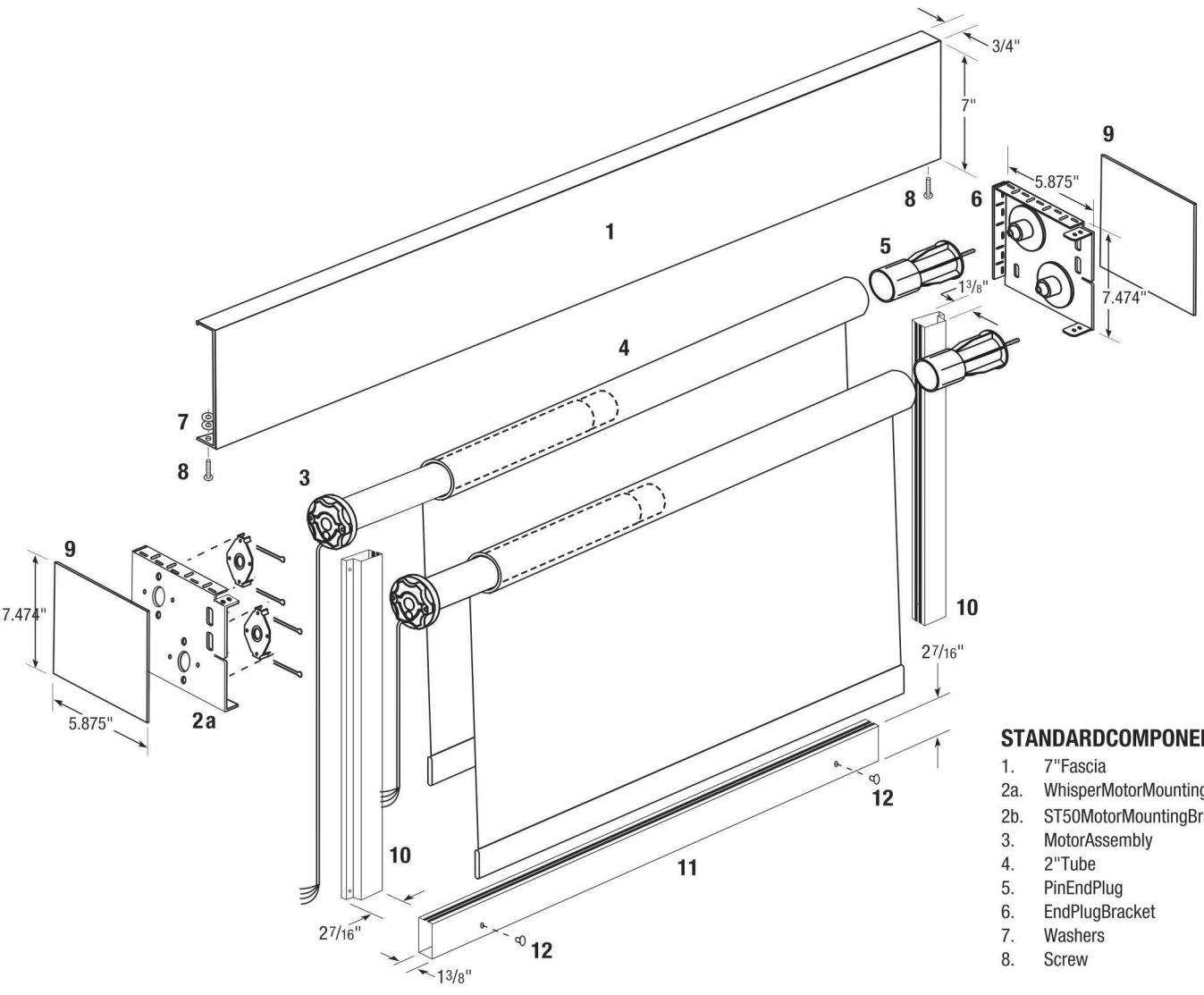

### STANDARDCOMPONENTS:

1. 7" Fascia
- 2a. Whisper Motor Mounting Bracket
- 2b. ST50 Motor Mounting Bracket
3. Motor Assembly
4. 2" Tube
5. Pin End Plug
6. End Plug Bracket
7. Washers
8. Screw

### OPTIONALCOMPONENTS:

9. Fascia End Plate
  10. Blockout Side Channel
  11. Blockout Bottom Channel
  12. Mounting Hole Plugs
- Fabric Covered Bottom Bar, Flat

### FASCIA&BRACKETCOLORS:

- Vanilla • White • Bronze
  - Anodized • Black
- (See page 4-2 for color chart.)

### POCKETPROFILES:

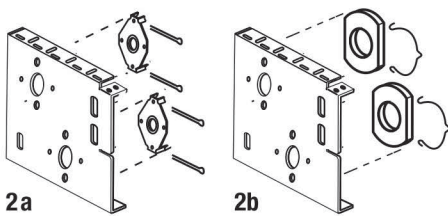
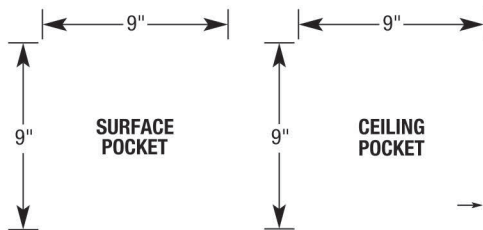

### SHADESIZES&WEIGHTS:

MOTOR MODEL	SHADE WIDTH	SHADE DROP	MAXIMUM WEIGHT	TUBE SIZE	MAXIMUM ROLL-UP DIAMETER*
ST50RTS	45"-156"	12"-144"	35lbs.	2"	4 5/8"
ST50Std	45"-156"	12"-144"	35lbs.	2"	4 5/8"



[WWW.LOUVOLUX.COM](http://WWW.LOUVOLUX.COM)